



**NOW LEASING**

*Publix at Sandtown Crossing*

5827 Campbellton Road  
ATLANTA, GEORGIA 30331

## PROPERTY OVERVIEW

Sandtown Crossing is a 35 acre mixed use development at the corner of Camp Creek Parkway and Campbellton Road in the heart of the strong residential communities of the City of South Fulton in Southwest Fulton County. It is located close to the many businesses of Fulton Industrial Boulevard, and is between three major county schools.

The property has traffic signals on both its Camp Creek and Riverside Drive corners, and has four curb cuts along Campbellton Road and Riverside Drive

### TRAFFIC COUNTS

25,800 vpd	Camp Creek Parkway
13,500 vpd	West of Camp Creek Parkway

### DEMOGRAPHICS

Miles	1	3	5
Population	4,054	23,296	74,910
Households	1,403	8,718	28,683
Median HH Income	\$120,513	\$100,173	\$81,343

## PRELIMINARY SITE PLAN

## HIGHLIGHTS

- » New 67,000sf shopping center opening Fall 2020
- » Publix opening new prototype 48,000sf store

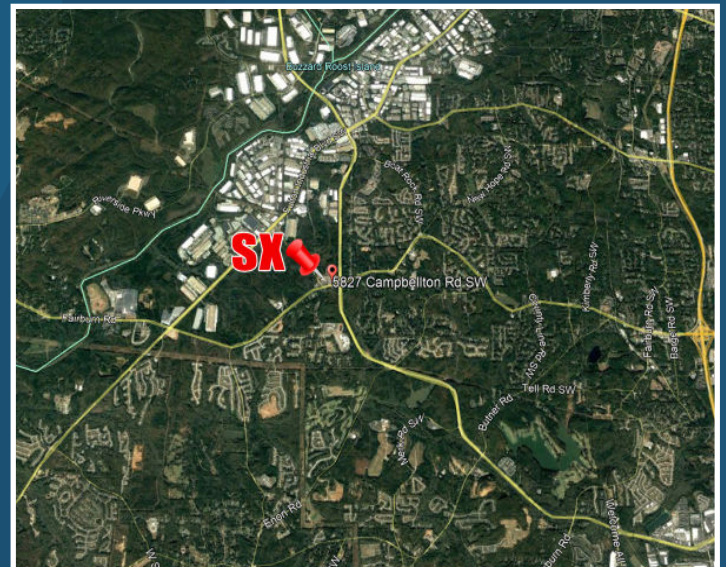
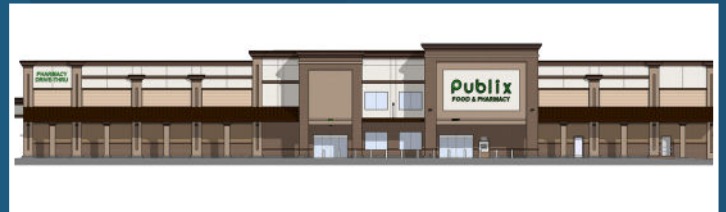



**ADAMS  
& COMPANY**

**Publix at Sandtown Crossing**

OWNED & OPERATED BY  
ADAMS & CO. REAL ESTATE, INC.

**(404) 255-7535**

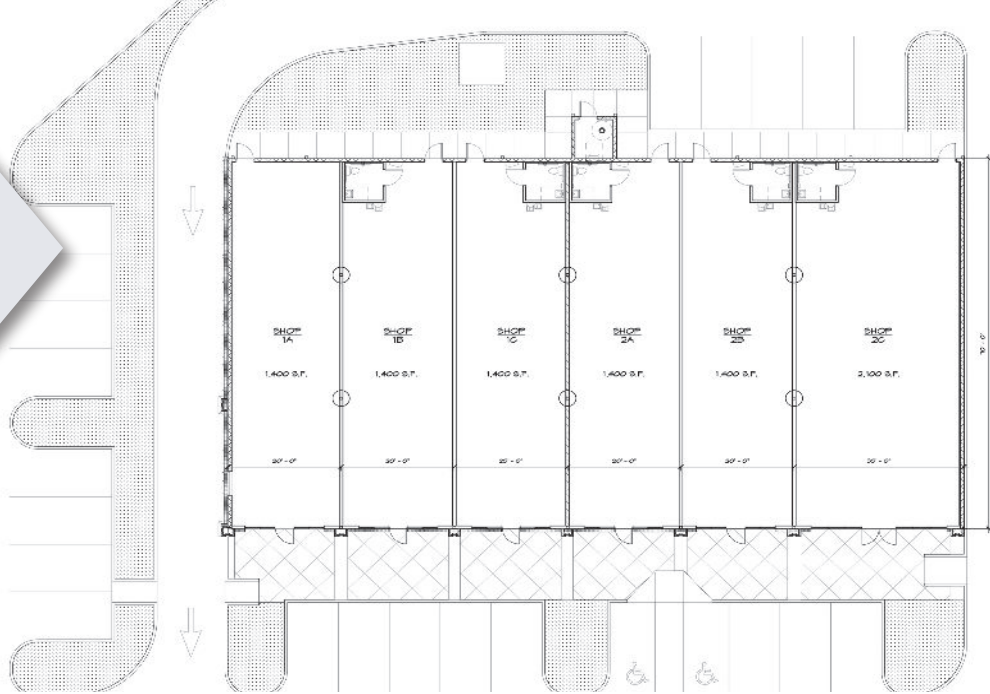

**West Shops**



**East Shops**

**AVAILABLE SUITES**

East Shops building of 9,100sf:  
2,100sf plus 1,200sf patio for restaurant use

7,000sf in 1,400sf increments for retail, limited  
seating food service or office use

**AVAILABLE SUITES**

West Shops building of 9,100sf:  
1,400sf endcap with drivethrough lane (can be larger)

Approx. 4,200sf available for restaurant use (including  
endcap)